

QDC1620B

High Power, High Isolation

Features:

- * High Power
- * High Isolation
- * Low Insertion Loss
- * Low VSWR

Applications:

- * Wireless
- * Radar
- * Laboratory Test

Description

QDC1620B series Drop-In Circulators cover frequency range 6~18GHz. High power, high isolation and low insertion loss make it ideal for a lot of applications like amplifiers, transceivers, etc.

Specifications

Frequency (MHz)	Bandwidth (MHz)	Insertion Loss (dB Max.)	Isolation (dB Min.)	VSWR (Max.)	Average Power (W)	Temperature (°C)
6000~18000	12000	1.5	10	1.9	20	-30~+70

Outline Drawings

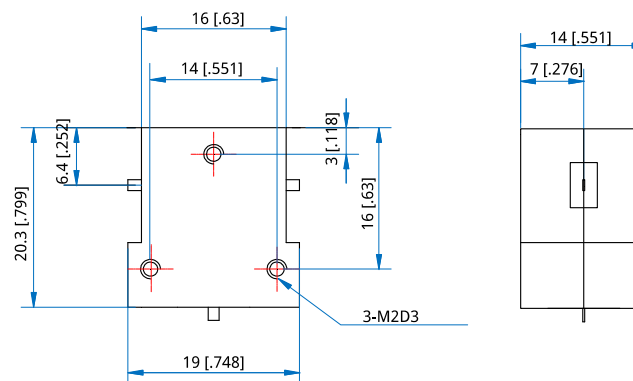

Unit: mm [inch] Tolerance: $\pm 0.2\text{mm}$ [$\pm 0.008\text{in}$]

Mechanical

Size^{*1}: 16*20.3*14mm
0.63*0.799*0.551in
Connector Type: Strip line
Mounting: 3-M2mm deep 3 mm

[1] Exclude connectors

Direction Naming Rules:

- 1 - Clockwise
- 2 - Anticlockwise

How To Order

QDC1620B-W-X-Y-Z

W: Start frequency in MHz

X: Stop frequency in MHz

Y: Average Power in W

Z: Direction type

Examples:

To order a QDC1620B series Circulator, 6~18GHz, 20W, Clockwise, specify QDC1620B-6000-18000-20-1.

Customization is available upon request.